



DRAINING A RETAINING WALL PROPOSALS

Proposal n.1

Our proposal for draining the retaining wall involves the use of our DRENTER 1.000 drainage modules (2 x 1 x 0.3 m), arranged according to the configuration with drainage pillars, as shown in figure 1.

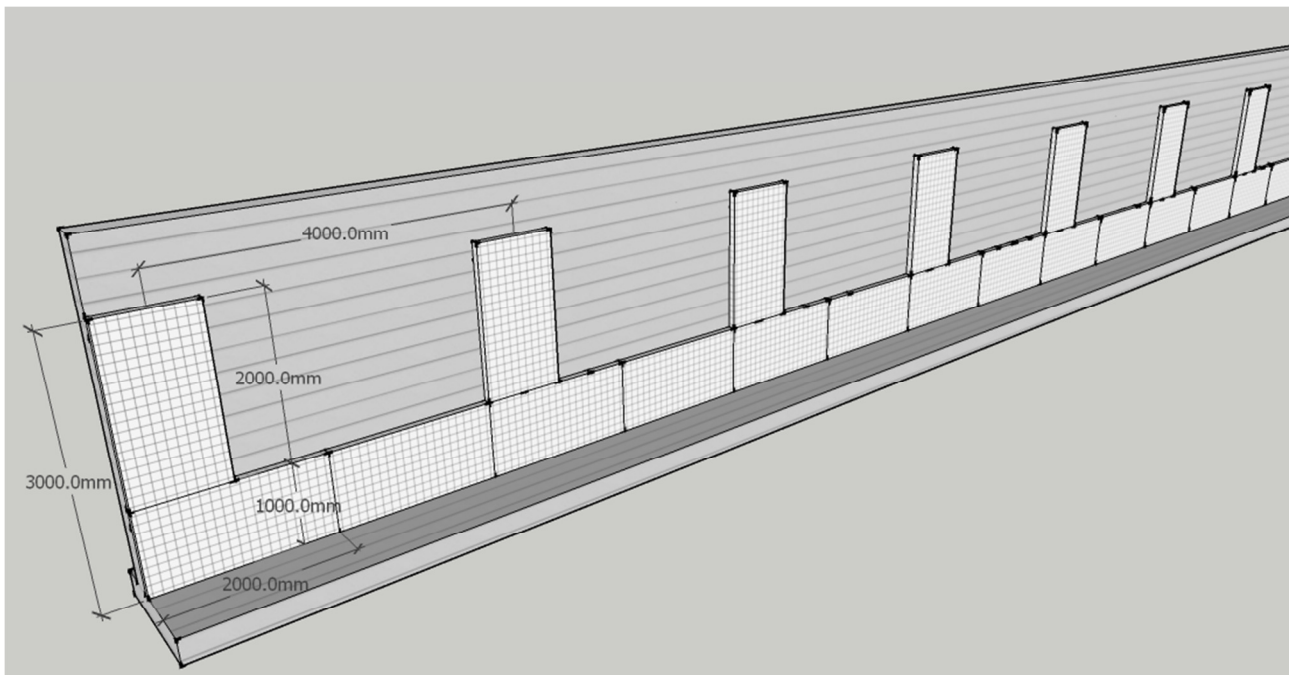

Fig.1. Arrangement of drainage pillars, wheelbase of 4 m

Idroter di Martinelli Francesco
Via Savonarola 217
Padova
Phone +390498979925
Fax +390495224306
www.idroter.com
info@idroter.com



A row of DRENTER 1000 is provided with a waterproofing liner at the base of the trench serving as a channel for the evacuation of captured water (Fig.2), at the top of which DRENTER 1000 are arranged vertically with a drain distance of 4 m.

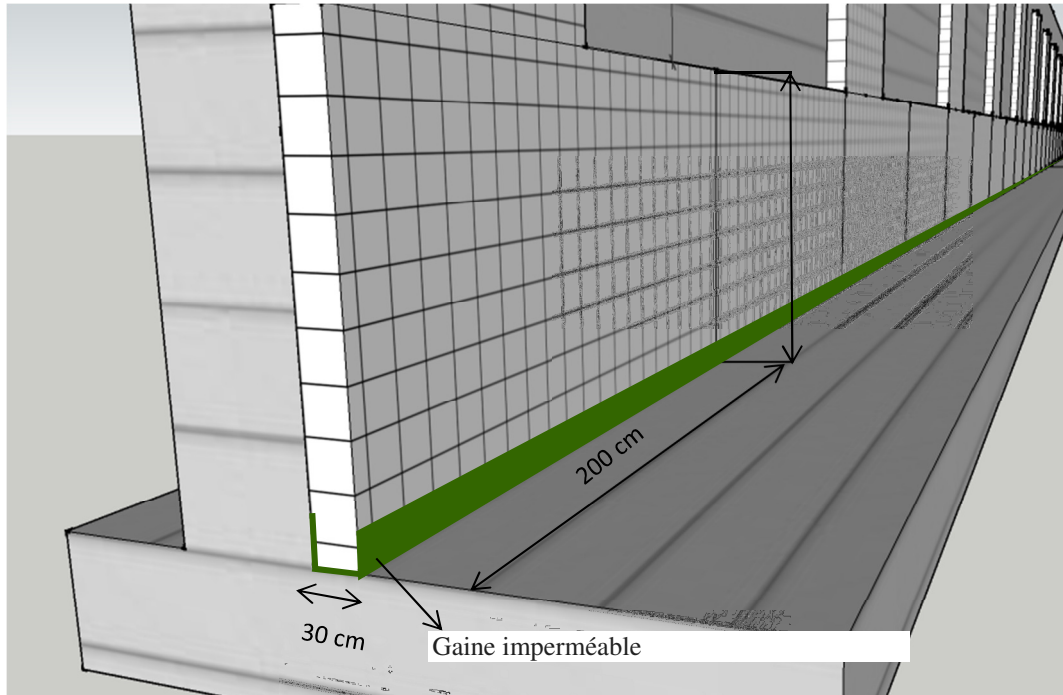

Fig.2. Detail of the green liner placed at the base of the excavation

Idroter di Martinelli Francesco
Via Savonarola 217
Padova
Phone +390498979925
Fax +390495224306
www.idroter.com
info@idroter.com



Proposal n.2

Variant

The recommended alternative is to have 4 rows of DRENTER SLIM Drainage Panels on top of one another to cover the entire wall surface as shown in Figure 3.

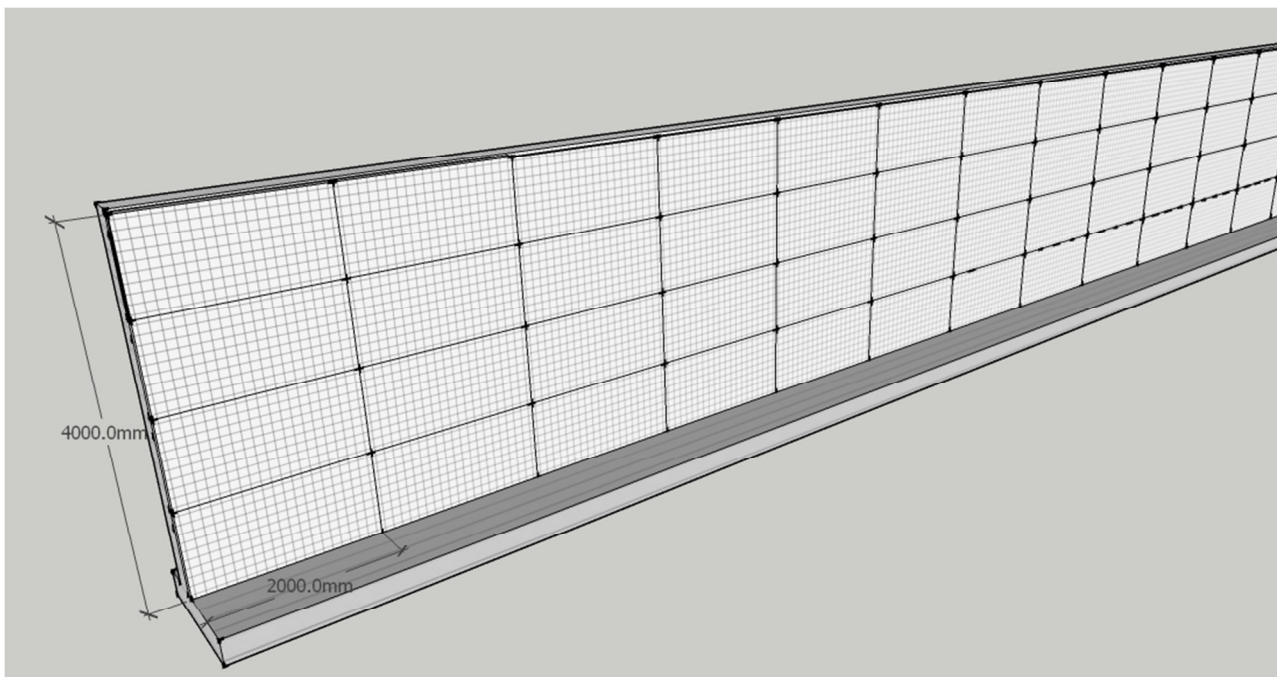

Fig.3. DRENTER 1.000 to 4 rows

End of the document

Copyright IDROTER DI MARTINELLI FRANCESCO 2019 ALL RIGHTS RESERVED

Idroter di Martinelli Francesco
Via Savonarola 217
Padova
Phone +390498979925
Fax +390495224306
www.idroter.com
info@idroter.com